

REEVE

CE 0082

EN 12278: 2007

UK
CA
8509

NFPA



7 ≤ Ø ≤ 13 mm



XF 494-2004: FZL-H-T 9.5/13

WARNING / ATTENTION

Activities involving the use of this equipment are inherently dangerous. You are responsible for your own actions and decisions.

Before using this equipment, you must:

- Read and understand all instructions for Use.
- Get specific training in its proper use.
- Become acquainted with its capabilities and limitations.
- Understand and accept the risks involved.



FAILURE TO HEED ANY OF THESE WARNINGS MAY RESULT IN SEVERE INJURY OR DEATH.

Les activités impliquant l'utilisation de cet équipement sont par nature dangereuses. Vous êtes responsable de vos actes, de vos décisions et de votre sécurité.

Avant d'utiliser cet équipement, vous devez :

- Lire et comprendre toutes les instructions d'utilisation.
- Vous former spécifiquement à l'utilisation de cet équipement.
- Vous familiariser avec votre équipement, apprendre à connaître ses performances et ses limites.
- Comprendre et accepter les risques induits.



LE NON-RESPECT D'UN SEUL DE CES AVERTISSEMENTS PEUT ÊTRE LA CAUSE DE BLESSURES GRAVES OU MORTELLES.

PETZL.COM



Latest version
Dernière version



Other languages
Autres langues



Technical tips
Conseils techniques



PPE checking
Fiche de contrôle EPI

Warning symbols
Panneaux d'alertes



PETZL
FR-38920 Croles
Cidex 105A
PETZL.COM
ISO 9001 © Petzl



Sustaining our Community
Au service de la Communauté
FONDATION-PETZL.ORG

Traceability and markings
Traçabilité et marquage

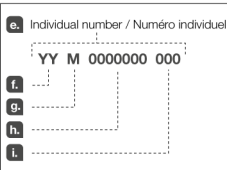
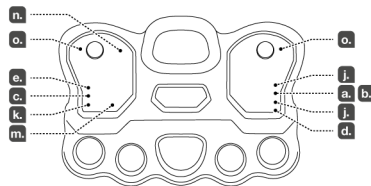
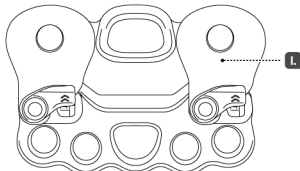

NFPA CERTIFICATION FOR REEVE

MEETS THE PULLEY AND AUXILIARY EQUIPMENT REQUIREMENTS OF NFPA 1983, INCORPORATED IN THE 2022 EDITION OF NFPA 2500. MINIMUM BREAKING STRENGTH AND RATING ARE DETERMINED AT THE CONFIGURATION OF LOWEST STRENGTH PER MANUFACTURER'S INSTRUCTIONS.



PULLEY: MBS 36 kN
AUXILIARY EQUIPMENT : MBS 36kN
G (GENERAL USE)
NFPA 2500 (1983) - 2022

After removing the Instructions for Use from the equipment, make a copy of it and keep the original as part of a permanent record that includes the usage and inspection history for the equipment. Keep the copy of the Instructions for Use with the equipment and refer to it before and after each use. Additional information regarding auxiliary equipment can be found in NFPA 1500 and NFPA 1858 and NFPA 1983, incorporated in the 2022 edition of NFPA 2500.

CERTIFICATION NFPA POUR REEVE

CONFORME AUX EXIGENCES POULIE ET EQUIPEMENTS AUXILIAIRES DE LA NORME NFPA 1983, RÉPOND AUX EXIGENCES NFPA 1983, DE L'ÉDITION 2022 DE LA NFPA 2500.

LA CHARGE DE RUPTURE EST DÉTERMINÉE SUR LA CONFIGURATION DE RÉSISTANCE MINIMUM SELON LES INSTRUCTIONS DU FABRICANT.



PULLEY: MBS 36 kN
AUXILIARY EQUIPMENT : MBS 36kN
G (GENERAL USE)
NFPA 2500 (1983) - 2022

Après avoir détaché la notice du produit, faites en une copie et gardez l'original dans un dossier qui compile l'historique de vie du produit et les vérifications EPI réalisées. Gardez une copie de la notice avec le produit et consultez-la avant et après chaque utilisation. Des informations complémentaires sont disponibles dans la NFPA 1500, NFPA 1858 et NFPA 1983, incorporées dans l'édition 2022 de la norme NFPA 2500.

1. Field of application (text part) Champ d'application (partie texte)

2. Nomenclature

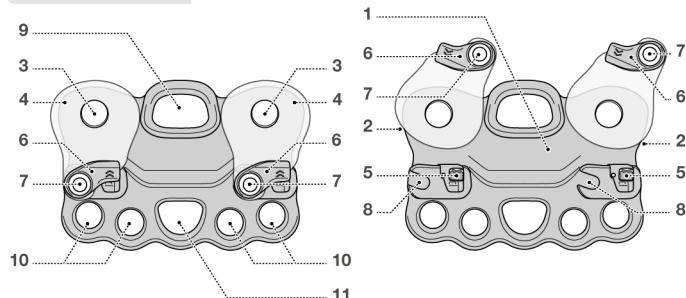

3. Inspection, points to verify
Contrôle, points à vérifier



PPE checking
Vérification EPI
PETZL.COM



4. Compatibility
Compatibilité

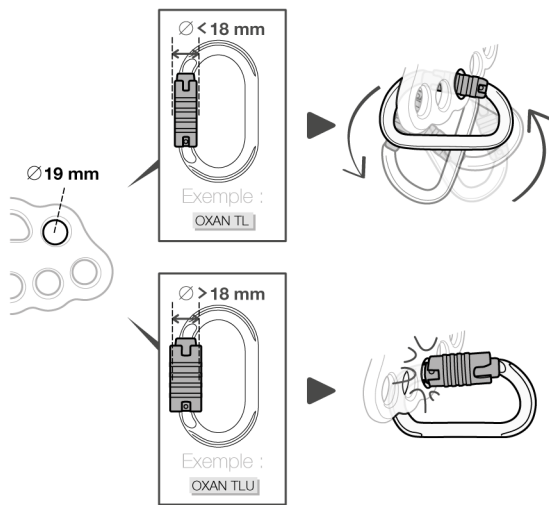
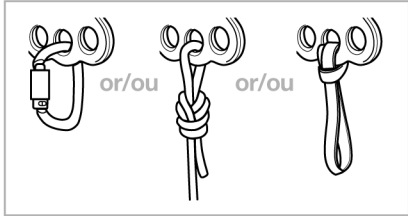

6. Precautions for use
Précautions d'utilisation

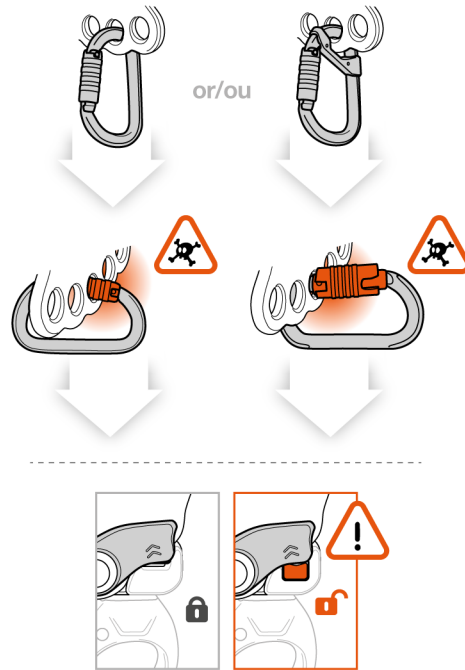

5. Opening and closing the pulleys
Ouverture et fermeture des poulies

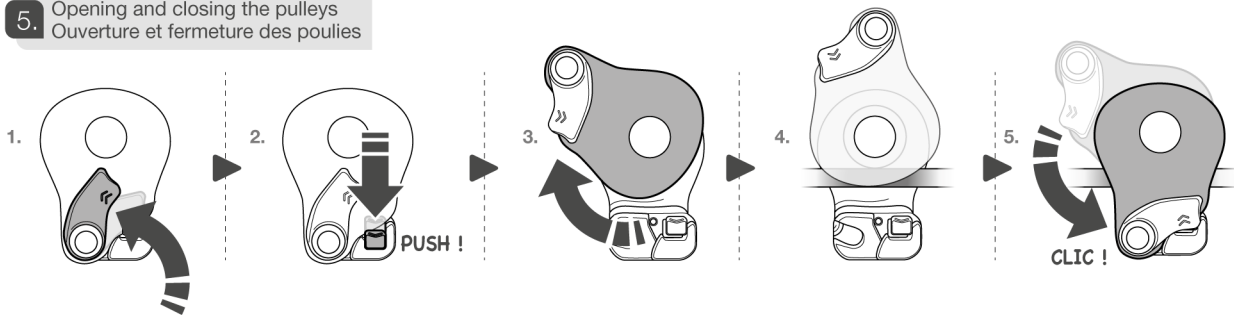

7. Performances

Breaking load
Charge de rupture

7a. On pulleys
7a. Sur poulies

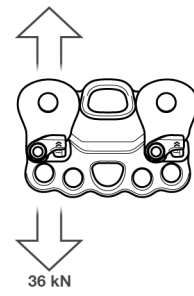
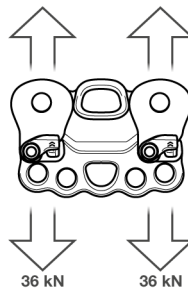
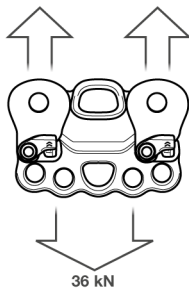

7b. On attachment holes
7b. Sur trous de connexion

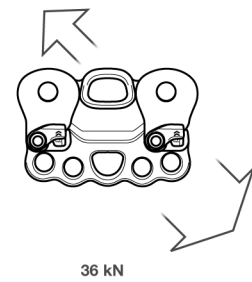
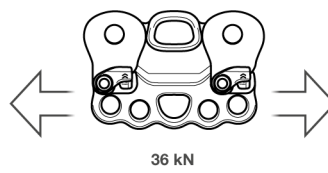
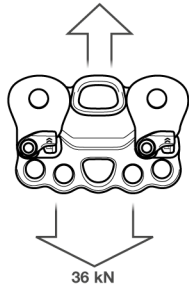

7a. On pulleys
7a. Sur poulies

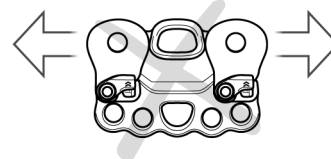
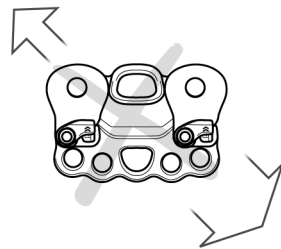

7d. Working load limit
7d. Charge d'utilisation maxi

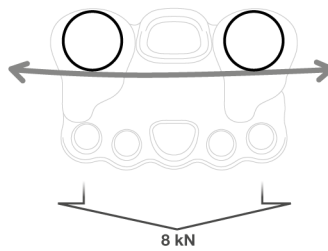
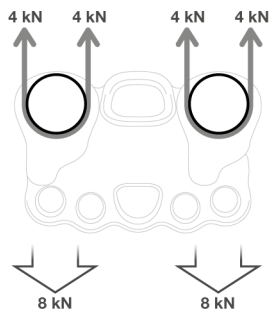

7e. Efficiency
7e. Efficacité

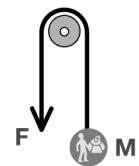

$F = 1,05 M$

8. Setup examples
Exemples d'installation

8a.
8a. Chariot pour tyrolienne en secours

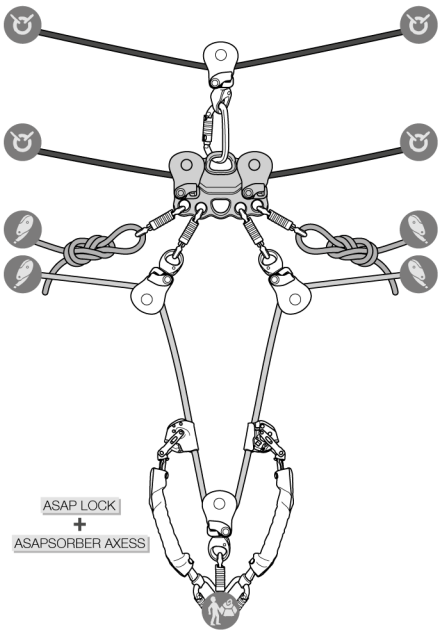

On a sloping tensioned highline
Sur tyrolienne oblique

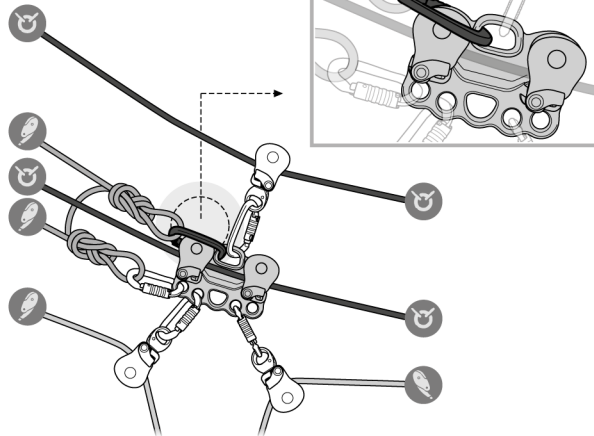

On two parallel working lines
Sur deux cordes de travail parallèles



Or /
Ou

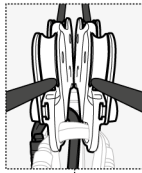

Or /
Ou

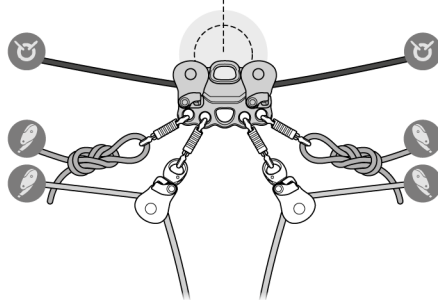
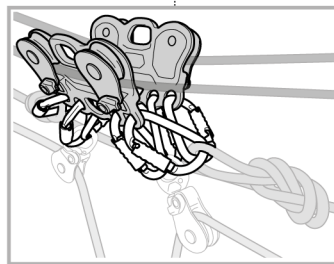
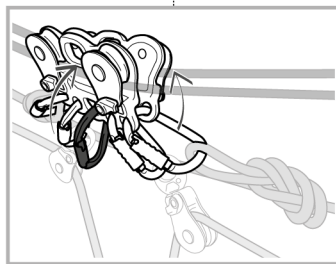
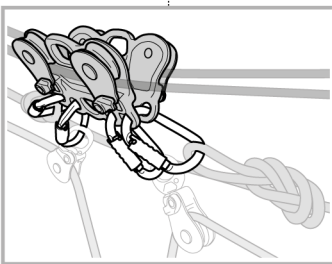
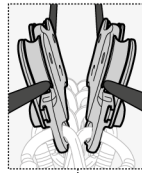

8b. Pulley for hauling system
8b. Poulie pour système de mouflage



9. Additional information
Informations complémentaires

A. Lifetime / Durée de vie



unlimited
illimitée

B. Acceptable T°
T° tolérées



C. Precautions for use / Précautions d'usage



D. Cleaning / Nettoyage



E. Drying / Séchage



F. Storage - Transport
Stockage - transport



H. Modifications - Repairs
Modifications - Réparations

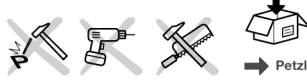

I. FAQ - Contact
Questions - Contact



G. Maintenance
Entretien



China standards /
中国标准

When operating under the XF 494-2004 standard for firefighters, use only a 9,5-13 mm diameter Light or General Use kernmantle Life Safety Rope.

当在消防的XF 494-2004标准下使用时，只能使用直径9,5-13 mm的轻型或通用夹芯生命安全绳索



This product is compliant with the Regulation 2016/425 on Personal Protective Equipment as amended to apply in Great Britain. The UK declaration of conformity is available at Petzl.com

Ce produit est conforme au règlement 2016/425 sur les équipements de protection individuelle tel que modifié pour s'appliquer en Grande-Bretagne. La déclaration de conformité UK est disponible sur Petzl.com

Approved Body performing the UKCA type examination:

Organisme approuvé intervenant pour l'examen UKCA de type :

SGS United Kingdom Ltd
Inward Way
Rossmore Business Park
Ellesmere Port, Cheshire, CH65 3EN
United Kingdom
N° 0120

Approved body responsible for the production control of this PPE:
Organisme approuvé responsable du contrôle de production de cet EPI :

Product Assessment and Reliability Centre Ltd Bideford
EX39 4LQ United Kingdom
N°8509

Authorized Representative in UK : PETZL UK Agency, Unit 3-7, Tebay Business Park, Old Tebay, Penrith, CA10 3SS, United Kingdom

